

New

Koyo



Stainless Steel Ball Bearing Units Corrosion Resistant



JTEKT

Koyo TOYODA

Stainless Steel Ball Bearing Units

"Corrosion Resistant..."

Introduction

With a legacy of Quality & Performance, **Koyo Ball Bearing Units** are the most reliable products when it comes to accuracy and excellent load resistance. Ball bearing units consist of a housing with an installed bearing. They are available in a variety of materials and housings allowing easy handling and installation.

Besides our traditional cast iron ball bearing units we also offer a selection of housings and bearing inserts in **high-grade stainless steel**, which makes them resistant to frequent wash-down, abrasive and corrosive environments. The effects of these circumstances will be minimized, thereby increasing bearing life while reducing operating costs.

Our stainless steel series are ideal for applications in the food, pharmaceutical and chemical industry, cleaning equipments, fertilizer, salt spreaders and various other applications.

Features - Redesigned for easy washdown

The redesigned shape and laser marked housings make the surface of our stainless steel housings smoother than ever. The flatter surface ensures there is no place for water to remain after washdown. The smooth housing and solid base reduce the risk of bacterial growth.

Our new stainless steel units accept both stainless and plastic covers. The plastic covers include a drain hole to allow any water that gets inside the cover to drain out.

Our stainless steel ball bearing units are available in different sizes and types and offer the same superior features and capabilities as our traditional ball bearing units, but providing a huge difference in bearing life and reduction in operating costs when being used in corrosive environments:

- ✓ **Corrosion Resistant**
- ✓ High load capacity and accuracy
- ✓ Superior sealing performance
- ✓ Highly rigid and strong housing
- ✓ **Increase in bearing life while reducing operating costs**
- ✓ Self-aligning mechanism and optimal fit
- ✓ Easy lubrication
- ✓ Simple installation and handling

Stainless Steel range*



* "J-fitting" is standard for Koyo, "H" and "K" are optional.

Stainless material composition:

Housing material	SUS316 Grade (SCS14)	Grease filling	H1 Food Grade (FDA / USDA) - Optional
Insert bearing material	SUS440C >>> Outer ring/Inner ring/Balls	Clearance	C3
	SUS304 >>> Cage/Slinger	Seals	NBR
	SUS304 >>> Set screw/Anti rotation pin		

Stainless Steel Ball Bearing Inserts

"Corrosion Resistant..."

New Seal Design for high performance lubrication



S6 = STAINLESS STEEL INSERT

S7 = ZINC PLATED BEARING STEEL INSERT (ONLY ON REQUEST)



New Twin lip seal design for lubrication

Test Results "New Seal Design"

1. Dust resistance test

1.1 Test conditions

- (1) Test unit: UCSFL205S6
- (2) Seal: Twin lip design
- (3) Rotational speed: 510 r/min
- (4) Load: Belt tension
- (5) Fine particle: Abrasive

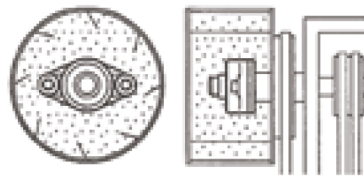

Fig. 4: Dust resistance test

1.2 Test results

Test	Test hours	Results
Product with new Twin lip seal design	1.000	After the test we have investigated if the fine particles have entered inside of the bearing. It can be concluded that hardly any fine particles have been found. Moreover, significant degradation of grease or abrasion of raceway grooves on the inner/outer rings and balls have not been found.
	>2.000	No abnormality in the bearings have been found.
Current product	500	Unusual noise generation and dust has entered

2. Heat generation and torque test

2.1 Test conditions

- (1) Test unit: UC208
- (2) Seal: Twin lip design
- (3) Rotational speed: Various speeds (start to 3.300 r/min.)
- (4) Load: No load

2.2 Test results

Table: Test results (rotating torque)

Unit: mNm

Spec.	Rotational speed (r/min.)							
	start	500	1.000	1.500	2.000	2.500	3.000	3.300
Current product	70	170	180	210	200	200	210	210
Product with a lip of new shape	50	120	130	170	170	180	180	190

→ The test results show that the rotational torque of the new design is reduced compared to the old design.

3. Conclusion

(1) Dust resistance test

An effect due to the design change is considered to be obtained because the test results shows the dust resistance is over two times larger than that of the current product.

(2) Rotating torque

The change of the seal design has resulted in a lower rotating torque.

Corrosion Resistant Series Pillow Block Units

UCSP-S6

Cylindrical bore (with set screws)

d 12 ~ 65 mm

With Pressed Stainless Steel Cover

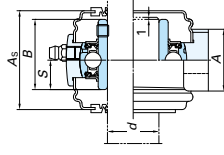

With Plastic Cover

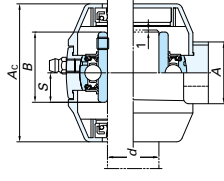

Variations of tolerance of distance from mounting bottom to center of spherical bore (3 mm)

Housing No.	3 mm
SP203-SP210	+0.15
SP211-SP213	+0.2

Unit: mm

Note: Cover groove is standard in all Stainless Steel housings.

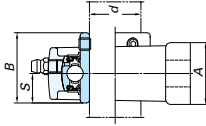
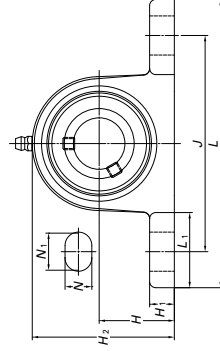

Shaft Dia. mm	Dimensions																	Bolt Size inch mm	Standard Housing No.		Basic Load Ratings kN	Factor	With Pressed Stainless Steel Cover		With Plastic Cover				
	H	L	A	J	N	N1	H1	H2	L1	B	S	M1	L	Unit No.	Housing No.	Bearing No.	Mass		Load Ratings	C1			C0r	f0	Open Type	One Side Closed Type	Dimension mm	Mass	Open Type
12	1 1/2	5	1 3/16	3 3/4	1/2	23/32	7/16	2 1/32	1 15/32	1 1079	0 453	3/8	M10	UCSP201X56 UCSP201-8X56	SP203	UC201X56 UC201-8X56	0 47	8 15	3 85	13 2	—	—	—	—	—	—	—	—	—
15	5/8	3 0.2	1 27	30	95	13	18	11	56	37.5	27.4	11.5	M10	UCSP202X56 UCSP202-10X56	SP203	UC202X56 UC202-10X56	0 47	8 15	3 85	13 2	—	—	—	—	—	—	—	—	—
17	1 1/8	5 33.3	1 5/8	33.3	95	13	18	11	63	33	31	12.7	M10	UCSP203X56 UCSP203-1256	SP204	UC203X56 UC203-1256	0 6	10 9	5 35	13 2	—	—	—	—	—	—	—	—	—
20	7/8	1 1/16	5 1/2	1 3/16	4 1/8	1/2	3/4	15/32	2 3/32	1 7/16	1 343	0 563	3/8	UCSP20456 UCSP205-1456 UCSP205-1556	SP205	UC20456 UC205-1456 UC205-1556	0 6	10 9	5 35	13 2	—	—	—	—	—	—	—	—	—
25	1	3 6.5	1 7/8	1 3/8	105	13	19	12	69	36.5	34.1	14.3	M10	UCSP2061856 UCSP206-1856	SP206	UC2061856 UC206-1856	1 1	16 5	9 05	13 9	—	—	—	—	—	—	—	—	—
30	1 1/8	4 2.9	1 1/2	1 13/16	4 3/4	2 1/2	1 3/4	1 13/16	3 3/16	1 23/32	1 500	0 626	1/2	UCSP2072056 UCSP207-2056	SP207	UC2072056 UC207-2056	1 4	21 8	12 3	13 9	—	—	—	—	—	—	—	—	—
35	1 1/4	4 7.6	1 5/8	1 1/2	5	2 1/2	1 3/4	1 13/16	3 9/16	1 17/32	1 689	0 689	1/2	UCSP2082456 UCSP208-2456	SP208	UC2082456 UC208-2456	1 7	24 8	14 3	14 0	—	—	—	—	—	—	—	—	—
40	1 1/2	5 49.2	1 3/4	1 5/8	5 1/2	2 1/2	1 3/4	1 13/16	3 1/2	1 11/16	1 937	0 748	1/2	UCSP2092756 UCSP209-2756	SP209	UC2092756 UC209-2756	2	27 8	16 2	14 0	—	—	—	—	—	—	—	—	—
45	1 5/8	6 54	1 7/8	1 5/8	6 1/4	2 3/2	1 5/8	1 13/16	3 7/8	1 47/64	1 937	0 748	1/2	UCSP2102856 UCSP210-2856	SP210	UC2102856 UC210-2856	2 5	29 8	18 6	14 4	—	—	—	—	—	—	—	—	—
50	1 7/8	7 57.2	1 7/8	1 7/8	6 1/4	2 3/2	1 5/8	1 13/16	3 7/8	1 47/64	1 937	0 748	1/2	UCSP2113056 UCSP211-3056	SP211	UC2113056 UC211-3056	3 4	36 8	23 5	14 4	—	—	—	—	—	—	—	—	—
55	2	8 63.5	1 7/8	1 7/8	6 3/4	2 3/2	1 5/8	1 13/16	3 7/8	1 47/64	1 937	0 748	1/2	UCSP2123256 UCSP212-3256	SP212	UC2123256 UC212-3256	4 5	44 5	29	14 4	—	—	—	—	—	—	—	—	—
60	2 1/8	9 69.8	1 7/8	1 7/8	6 3/4	2 3/2	1 5/8	1 13/16	3 7/8	1 47/64	1 937	0 748	1/2	UCSP2133556 UCSP213-3556	SP213	UC2133556 UC213-3556	5 8	48 2	32 1	14 4	—	—	—	—	—	—	—	—	—
65	2 1/2	10 76.2	1 7/8	1 7/8	7 1/4	2 3/2	1 5/8	1 13/16	3 7/8	1 47/64	1 937	0 748	1/2	UCSP2144056 UCSP214-4056	SP214	UC2144056 UC214-4056	5 8	56 8	36 1	14 4	—	—	—	—	—	—	—	—	—

Remarks 1. In Part No. of unit and units with covers, fitting codes follow bore diameter numbers.
 2. Part No. of applicable grease fittings are shown below.
 A-1/4-28UNF N13.....210X~210
 A-R1/8N13.....211~213

3. For the dimensions and forms of applicable bearings, see the dimensional tables of ball bearing for unit.



Corrosion Resistant Series Pillow Block Units

UCSPA-S6 Cylindrical bore (with set screws) d 12 ~ 50 mm

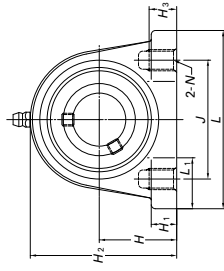
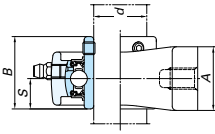

With Pressed Stainless Steel Cover

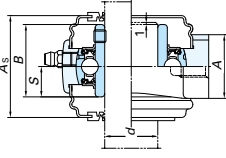

With Plastic Cover

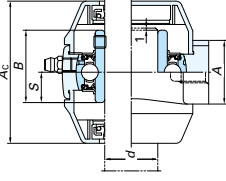

Variations of tolerance of distance from mounting bottom to center of spherical bore (B_{min}) and variations of tolerance of distance between centers of bolt holes (B_{max})

Housing No.	B_{min}	B_{max}	Unit:mm
SPA203-SPA210	± 0.15	± 0.5	

Note: Cover groove is standard in all Stainless Steel housings.

Shaft Dia mm	Dimensions		Standard										Basic		With Pressed Stainless Steel Cover		With Plastic Cover		Mass
	inch	mm	Unit No.	Housing No.	Bearing No.	Mass kg	Load Ratings kN	Factor	Open Type	One Side Closed Type	Dimension mm	inch	Mass kg	Open Type	One Side Closed Type	Dimension mm	inch	Mass kg	
12	1/2		UCSPA201X56	UC201X56															
15	5/8	3	1 3/16	2 3/4	1 1/2	2 1/4	31/64	7/8	1.079	0.453									
		30.2	76	30	52	M10x1.5	10	57	13	22	27.4	11.5							
17	3/4	3	1 3/16	2 3/4	1 1/2	2 3/8	31/64	7/8	1.220	0.500									
		30.2	76	30	52	M10x1.5	10	60	13	22	31	12.7							
25	1 1/8	3 1/2	3 5/16	2 13/16	1 1/2	2 3/8	31/64	15/16	1.343	0.563									
		36.5	84	30	56	M10x1.5	12	69	13	24	34.1	14.3							
30	1 1/4	4	3 11/16	2 13/16	1 1/2	2 3/8	31/64	1 3/32	1.500	0.626									
		42.9	94	36	66	M14x2	12	81	18	28	38.1	15.9							
35	1 3/8	4 1/2	4 11/32	3 3/32	1 1/2	3 19/32	35/64	1 3/16	1.689	0.689									
		47.6	110	38	80	M14x2	13	91	20	30	42.9	17.5							
40	1 7/8	5	4 9/16	3 3/16	1 1/2	3 13/16	35/64	1 1/4	1.937	0.748									
		49.2	116	40	84	M14x2	13	97	20	32	49.2	19							
45	1 7/4	5 1/2	4 23/32	3 3/4	1 3/4	4 3/32	39/64	1 1/4	1.937	0.748									
		54.2	120	40	90	M14x2	13	104	25	32	49.2	19							
50	1 7/8	6	5 1/8	3 3/4	1 3/4	4 3/8	39/64	1 1/2	2.031	0.748									
		57.2	130	45	94	M16x2	14	111	25	36	51.6	19							
2			UCSPA210-3256	UC210-3256															

Remarks
 1. In Part No. of unit and units with covers, fitting codes follow bore diameter numbers.
 2. Part No. of applicable grease fitting is A-1/4-28UNF1.3.
 3. For the dimensions and forms of applicable bearings, see the dimensional tables of ball bearing for unit.



Corrosion Resistant Series Pillow Block Units

USP-S6 Cylindrical bore (with set screws) d 10 ~ 30 mm

Variations of tolerance of distance from mounting bottom to center of spherical bore (3rd fit) and variations of tolerance of distance between centers of bolt holes (3rd fit)

Housing No.	3 rd fit	3 rd fit	Unit: mm
SP000~SP006	±0.15	±0.4	

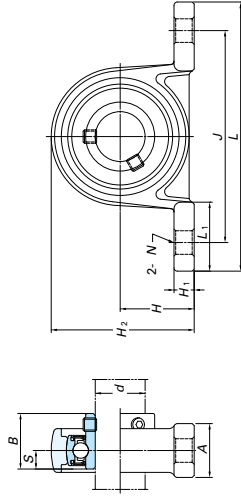
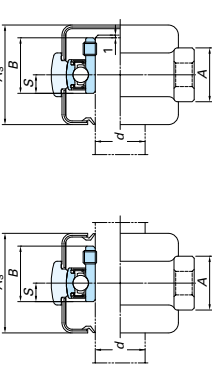

Note: Cover groove is standard in all Stainless Steel housings.

Shaft Dia. mm	Dimensions													Bolt Size	Unit No.	Standard Housing No.	Bearing No.	Mass kg	Basic Load Ratings		Factor	With Rubber Coated Cover		Mass kg
	H	L	A	J	N	H ₁	H ₂	L ₁	B	S	inch	mm	kN						C _r	C _{0r}		Unit No.	Dimension mm	
10	45/64	2 3/8	9/8	2 1/32	9/32	3/16	1 3/8	23/32	0.591	0.197	1/4	M6	5	5	5	12.3	3.9	1.55	12.3	USP000CS6	USP000CDS6	29	1 5/32	0.08
	18	67	16	53	7	5	35	18	15	5	M6	5	5	5	5	12.3	3.9	1.55	12.3	USP000CS6	USP000CDS6	29	1 5/32	0.08
12	3/4	2 25/32	5/8	2 1/32	9/32	3/16	1 15/32	23/32	0.591	0.197	1/4	M6	5	5	5	13.2	4.3	1.9	13.2	USP001CS6	USP001CDS6	29	1 5/32	0.08
	19	71	16	56	7	5	37	18.5	15	5	M6	5	5	5	5	13.2	4.3	1.9	13.2	USP001CS6	USP001CDS6	29	1 5/32	0.08
15	55/64	3 5/32	9/8	2 11/32	9/32	1/4	1 11/16	13/16	0.650	0.217	1/4	M6	5.5	5.5	5.5	13.9	4.7	2.25	13.9	USP002CS6	USP002CDS6	31	1 7/32	0.11
	22	80	16	63	7	6	42.5	20.5	16.5	5.5	M6	5.5	5.5	5.5	5.5	13.9	4.7	2.25	13.9	USP002CS6	USP002CDS6	31	1 7/32	0.11
17	15/16	3 11/32	23/32	2 5/8	9/32	1/4	1 13/16	13/16	0.689	0.236	1/4	M6	6	6	6	14.4	5.1	2.6	14.4	USP003CS6	USP003CDS6	33	1 5/16	0.14
	24	85	18	67	7	6	46	21	17.5	6	M6	6	6	6	6	14.4	5.1	2.6	14.4	USP003CS6	USP003CDS6	33	1 5/16	0.14
20	1 1/64	3 15/16	23/32	3 1/32	13/32	5/16	2 3/32	13/32	0.827	0.276	5/16	M8	7	7	7	13.9	7.9	4	13.9	USP004CS6	USP004CDS6	38	1 1/2	0.23
	28	100	20	80	10	8	54.5	25	21	7	M8	7	7	7	7	13.9	7.9	4	13.9	USP004CS6	USP004CDS6	38	1 1/2	0.23
25	1 17/64	4 13/32	25/32	3 11/32	13/32	11/32	2 13/32	1 3/32	0.866	0.276	5/16	M8	7	7	7	14.5	8.5	4.65	14.5	USP005CS6	USP005CDS6	40	1 9/16	0.28
	32	112	20	90	10	9	61	27.5	22	7	M8	7	7	7	7	14.5	8.5	4.65	14.5	USP005CS6	USP005CDS6	40	1 9/16	0.28
30	1 27/64	5 3/16	1 1/32	4 7/16	1/2	13/32	2 23/32	1 11/32	0.965	0.295	5/8	M10	7.5	7.5	7.5	14.7	11.2	6.6	14.7	USP006CS6	USP006CDS6	44	1 23/32	0.43
	36	132	26	106	13	10	69	34	24.5	7.5	M10	7.5	7.5	7.5	7.5	14.7	11.2	6.6	14.7	USP006CS6	USP006CDS6	44	1 23/32	0.43

Remarks 1. In Part No. of unit and units with covers, fitting codes follow bore diameter numbers.
2. For the dimensions and forms of applicable bearings, see the dimensional tables of ball bearing for unit.

Corrosion Resistant Series 4-Bolt Flange Units

UCSF-56

Cylindrical bore (with set screws)

d 20 ~ 65 mm

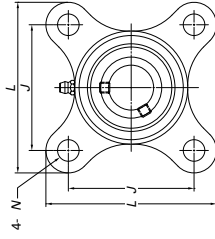
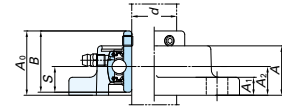

With Pressed Stainless Steel Cover

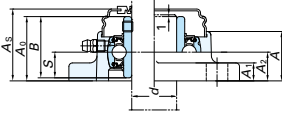

With Plastic Cover

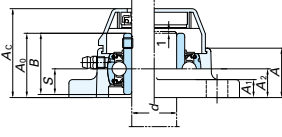

Variations of tolerance of distance from mounting surface to center of spherical bore (3-ax) and tolerance of position of bolt hole (X)

Housing No.	3-ax	X
SF204-SF210	+0.5	0.7
SF211-SF213	+0.8	1

Unit: mm

Variations of tolerance of bolt hole diameter (3-ax)

Housing No.	3-ax
SF204-SF213	+0.2

Unit: mm

Note: Cover groove is standard in all Stainless Steel housings.

Shaft Dia mm	Dimensions inch mm										Bolt Size inch mm	Unit No.	Standard Housing No.		Bearing No.	Mass kg	Basic Load Ratings kN		Factor	With Pressed Stainless Steel Cover		With Plastic Cover		Mass kg	
	L	A	J	N	A1	A2	A3	A4	A5	A6			C	C _{0r}			f ₀	Open Type		Closed Type	Unit No.	Open Type	Closed Type		Unit No.
20	3 3/8	1 1/32	2 3/64	15/32	13/32	19/32	1 3/16	1.220	0.500	12.7	M10	UCSF-204-1256 UCSF-20456	SF204	UC204-1256 UC20456	0.53	10.9	5.35	13.2	UCSF204C56	UCSF204D56	UCSF204VCS6	UCSF204VDS6	46	1 13/16	0.53
25	3 3/4	1 3/32	2 3/4	15/32	13/32	19/32	1 1/2	1.343	0.563	14.3	M10	UCSF-205-1456 UCSF-20556	SF205	UC205-1456 UC20556	0.68	11.9	6.3	13.9	UCSF205C56	UCSF205D56	UCSF205VCS6	UCSF205VDS6	49.5	1 9/16	0.68
	1											UCSF-205-1656 UCSF-205656		UC205-1656 UC205656											
30	4 1/4	1 7/32	3 1/64	15/32	13/32	19/32	1 1/2	1.500	0.626	15.9	M10	UCSF-206-1856 UCSF-20656	SF206	UC206-1856 UC20656	1.02	16.5	9.05	13.9	UCSF206C56	UCSF206D56	UCSF206VCS6	UCSF206VDS6	58	2 3/32	1.02
	1 1/4											UCSF-206-1956 UCSF-206656		UC206-1956 UC206656											
35	4 19/32	1 17/32	3 5/8	35/64	7/16	3/4	1 3/4	1.689	0.689	17.5	M12	UCSF-207-2056 UCSF-207256	SF207	UC207-2056 UC207256	1.3	21.8	12.3	13.9	UCSF207C56	UCSF207D56	UCSF207VCS6	UCSF207VDS6	62.5	2 19/32	1.30
	1 7/16											UCSF-207-2356 UCSF-207356		UC207-2356 UC207356											
40	5 1/8	1 15/32	4 7/64	5/8	19/32	31/64	2 1/32	1.937	0.748	19	M14	UCSF-208-2456 UCSF-208256	SF208	UC208-2456 UC208256	1.63	24.8	14.3	14.0	UCSF208C56	UCSF208D56	UCSF208VCS6	UCSF208VDS6	70	2 3/4	1.63
	1 3/4											UCSF-208-2656 UCSF-208356		UC208-2656 UC208356											
45	5 13/32	1 1/2	4 9/64	5/8	1/2	31/64	2 1/16	1.937	0.748	19	M14	UCSF-209-2756 UCSF-2092756	SF209	UC209-2756 UC2092756	1.92	27.8	16.2	14.0	UCSF209C56	UCSF209D56	UCSF209VCS6	UCSF209VDS6	75.5	2 31/32	1.92
	1 7/8											UCSF-209-2856 UCSF-209356		UC209-2856 UC209356											
50	5 5/8	1 9/16	4 3/8	5/8	1/2	31/64	2 5/32	2.031	0.748	19	M14	UCSF-210-3056 UCSF-210356	SF210	UC210-3056 UC210356	2.18	29.8	18.6	14.4	UCSF210C56	UCSF210D56	UCSF210VCS6	UCSF210VDS6	82	3 19/64	2.18
	2											UCSF-210-3256 UCSF-210356		UC210-3256 UC210356											
55	6 3/8	1 11/16	5 1/8	3/4	19/32	31/64	2 5/16	2.189	0.874	22.2	M16	UCSF-211-3456 UCSF-211356	SF211	UC211-3456 UC211356	3.01	36.8	23.5	14.4	UCSF211C56	UCSF211D56	UCSF211VCS6	UCSF211VDS6	89.5	3 17/32	3.01
	2 3/16											UCSF-211-3556 UCSF-211356		UC211-3556 UC211356											
60	6 7/8	1 7/8	5 5/8	3/4	19/32	1 9/64	2 25/32	2.563	1.000	25.4	M16	UCSF-212-3656 UCSF-212356	SF212	UC212-3656 UC212356	3.82	44.5	29	14.4	UCSF212C56	UCSF212D56	UCSF212VCS6	UCSF212VDS6	99	3 7/64	3.82
	2 7/16											UCSF-212-3956 UCSF-212356		UC212-3956 UC212356											
65	7 1/2	1 31/32	5 7/8	3/4	45/64	1 3/16	2 3/4	2.563	1.000	25.4	M16	UCSF-213-4056 UCSF-21356	SF213	UC213-4056 UC21356	5.02	48.2	32.1	14.4	UCSF213C56	UCSF213D56	UCSF213VCS6	UCSF213VDS6	105	4 9/64	5.02
	2 1/2																								

Remarks 1. In Part No. of unit and units with covers, fitting codes follow bore diameter numbers.

2. Part No. of applicable grease fittings are shown below.

A-1/4-28UNFNI3.....204~210

A-R1/8NI3.....211~213

3. For the dimensions and forms of applicable bearings, see the dimensional tables of ball bearing for unit.

Corrosion Resistant Series 4-Bolt Flange Units

UCSF-ES6

Cylindrical bore (with set screws)

d 20 ~ 65 mm

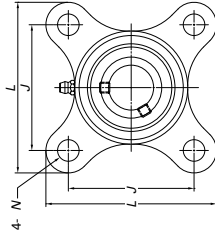
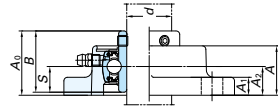

With Pressed Stainless Steel Cover

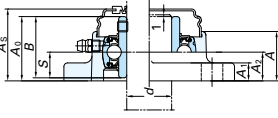

With Plastic Cover

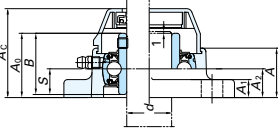

Variations of tolerance of distance from mounting surface to center of spherical bore (3-ab) and tolerance of position of bolt hole (X)

Housing No.	3-ab	X
SF204E-SF210E	+0.5	0.7
SF211E-SF213E	+0.8	1

Unit: mm

Variations of tolerance of bolt hole diameter (3-aa)

Housing No.	3-aa
SF204E-SF213E	+0.2

Unit: mm

Note: Cover groove is standard in all Stainless Steel housings.

Shaft Dia mm	Dimensions inch mm										Bolt Size inch mm	Unit No.	Standard Housing No.		Bearing No.	Mass kg	Basic Load Ratings kN		Factor	With Pressed Stainless Steel Cover		With Plastic Cover		Mass kg	
	L	A	J	N	A ₁	A ₂	A ₃	B	S	UCSF204-12ES6			UCSF204-14ES6	C _r			C _{0r}	Open Type		Unit No.	UCSF204EVD56	Unit No.	UCSF204EVD56		Open Type
20	3 3/8	1 1/32	2 3/64	7/16	13/32	19/32	1 3/16	1.220	0.500	12.7	M10	UCSF204-12ES6	SF204E	UC204-1256	0.53	10.9	5.35	13.2	UCSF204ECS6	UCSF204EVD56	UCSF204EVD56	46	1 13/16	0.53	
25	3 3/4	1 3/32	2 3/4	29/64	13/32	5/8	1 13/32	1.343	0.563	14.3	M10	UCSF205-14ES6	SF205E	UC205-1456	0.68	11.9	6.3	13.9	UCSF205ECS6	UCSF205ED56	UCSF205ED56	40	1 9/16	0.68	
	1	3 3/4	2 3/4	29/64	13/32	5/8	1 13/32	1.343	0.563	14.3	M10	UCSF205-16ES6	SF205E	UC205-1656	0.68	11.9	6.3	13.9	UCSF205ECS6	UCSF205ED56	UCSF205ED56	40	1 9/16	0.68	
30	4 1/4	1 7/32	3 1/64	31/64	13/32	45/64	1 19/32	1.500	0.626	15.9	M10	UCSF206-18ES6	SF206E	UC206-1856	1.02	16.5	9.05	13.9	UCSF206ECS6	UCSF206ED56	UCSF206ED56	45	1 25/32	1.02	
	1 3/16	108	31	83	13	10	18	40.2	38.1	15.9	M10	UCSF206-19ES6	SF206E	UC206-1956	1.02	16.5	9.05	13.9	UCSF206ECS6	UCSF206ED56	UCSF206ED56	45	1 25/32	1.02	
35	4 1/2	1 11/32	3 5/8	37/64	7/16	3/4	1 3/4	1.689	0.689	17.5	M12	UCSF207-21ES6	SF207E	UC207-2156	1.3	21.8	12.3	13.9	UCSF207ECS6	UCSF207ED56	UCSF207ED56	49	1 15/16	1.30	
	1 7/16	117	34	92	13	11	19	44.4	42.9	17.5	M12	UCSF207-23ES6	SF207E	UC207-2356	1.3	21.8	12.3	13.9	UCSF207ECS6	UCSF207ED56	UCSF207ED56	49	1 15/16	1.30	
40	5 1/8	1 13/32	4 7/64	35/64	19/32	31/64	2 1/32	1.937	0.748	19	M14	UCSF208-24ES6	SF208E	UC208-2456	1.63	24.8	14.3	14.0	UCSF208ECS6	UCSF208ED56	UCSF208ED56	56	2 7/32	1.63	
	1 9/16	130	36	102	14	12	21	51.2	49.2	19	M14	UCSF208-26ES6	SF208E	UC208-2656	1.63	24.8	14.3	14.0	UCSF208ECS6	UCSF208ED56	UCSF208ED56	56	2 7/32	1.63	
45	5 13/32	1 1/2	4 9/64	5/8	1/2	51/64	2 1/16	1.937	0.748	19	M14	UCSF209-27ES6	SF209E	UC209-2756	1.92	27.8	16.2	14.0	UCSF209ECS6	UCSF209ED56	UCSF209ED56	57	2 1/4	1.92	
	1 3/4	137	38	105	16	13	22	52.2	49.2	19	M14	UCSF209-28ES6	SF209E	UC209-2856	1.92	27.8	16.2	14.0	UCSF209ECS6	UCSF209ED56	UCSF209ED56	57	2 1/4	1.92	
50	5 7/8	1 9/16	4 3/8	5/8	1/2	51/64	2 5/32	2.031	0.748	19	M14	UCSF210-30ES6	SF210E	UC210-3056	2.18	29.8	18.6	14.4	UCSF210ECS6	UCSF210ED56	UCSF210ED56	59	2 5/16	2.18	
	1 7/8	143	40	111	16	13	22	54.6	51.6	19	M14	UCSF210-32ES6	SF210E	UC210-3256	2.18	29.8	18.6	14.4	UCSF210ECS6	UCSF210ED56	UCSF210ED56	59	2 5/16	2.18	
55	6 3/8	1 11/16	5 1/8	49/64	19/32	49/64	2 5/16	2.189	0.874	22.2	M16	UCSF211-32ES6	SF211E	UC211-3256	3.01	36.8	23.5	14.4	UCSF211ECS6	UCSF211ED56	UCSF211ED56	63	2 15/32	3.01	
	2 3/16	162	43	130	17	15	25	58.4	55.6	22.2	M16	UCSF211-35ES6	SF211E	UC211-3556	3.01	36.8	23.5	14.4	UCSF211ECS6	UCSF211ED56	UCSF211ED56	63	2 15/32	3.01	
60	6 7/8	1 7/8	5 7/8	47/64	19/32	1 9/64	2 23/32	2.563	1.000	25.4	M16	UCSF212-36ES6	SF212E	UC212-3656	3.82	44.5	29	14.4	UCSF212ECS6	UCSF212ED56	UCSF212ED56	73	2 7/8	3.82	
	2 7/16	175	48	143	17	15	29	68.7	65.1	25.4	M16	UCSF212-39ES6	SF212E	UC212-3956	3.82	44.5	29	14.4	UCSF212ECS6	UCSF212ED56	UCSF212ED56	73	2 7/8	3.82	
65	7 1/2	1 31/32	5 7/8	49/64	49/64	1 3/16	2 3/4	2.563	1.000	25.4	M16	UCSF213-40ES6	SF213E	UC213-4056	5.02	48.2	32.1	14.4	UCSF213ECS6	UCSF213ED56	UCSF213ED56	75	2 15/16	5.02	
	2 1/2	187	50	149	17	18	30	69.7	65.1	25.4	M16	UCSF213-42ES6	SF213E	UC213-4256	5.02	48.2	32.1	14.4	UCSF213ECS6	UCSF213ED56	UCSF213ED56	75	2 15/16	5.02	

Remarks 1. In Part No. of unit and units with covers, fitting codes follow bore diameter numbers.

2. Part No. of applicable grease fittings are shown below.

A-1/4-28UNFNI3.....204~210

A-R1/8NI3.....211~213

3. For the dimensions and forms of applicable bearings, see the dimensional tables of ball bearing for unit.

Corrosion Resistant Series 2-Bolt Flange Units

UCSFL-S6

Cylindrical bore (with set screws)

d 12 ~ 50 mm

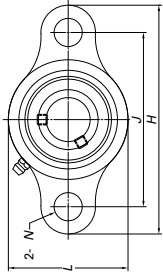
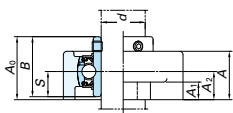

With Pressed Stainless Steel Cover

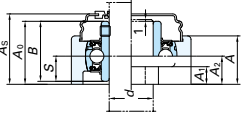

With Plastic Cover

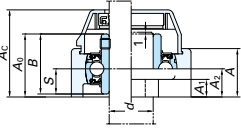

Variations of tolerance of distance from mounting surface to center of spherical bore (3 *a*₂) and variations of tolerance of distance between centers of bolt holes (3 *a*₁)

Housing No.	3 <i>a</i> ₂	3 <i>a</i> ₁	Unit: mm
SFL203-SFL210	±0.5	±0.5	±0.5

Variations of tolerance of bolt hole diameter (3 *w*₂)

Housing No.	3 <i>w</i> ₂	Unit: mm
SFL203-SFL210	±0.2	±0.2

Note: Cover groove is standard in all Stainless Steel housings.

Shaft Dia mm	Dimensions											Bolt Size	Unit No.	Standard Housing No.	Bearing No.	Mass	Basic Load Ratings		Factor	With Pressed Stainless Steel Cover		With Plastic Cover		Mass		
	<i>H</i>	<i>L</i>	<i>A</i>	<i>J</i>	<i>N</i>	<i>A</i> ₁	<i>A</i> ₂	<i>A</i> ₀	<i>B</i>	<i>S</i>	<i>d</i>						kg	<i>C</i> _r		<i>C</i> _{0r}	<i>f</i> ₀	Unit No.	Open Type		Closed Type	Dimension mm
12													UCSFL201X56	SFL203	UC201X56	0.33	8.15	3.85	13.2	UCSFL204CS6	UCSFL204DS6	UCSFL204VCS6	UCSFL204VDS6	46	1 13/16	0.47
15	3 37/32	2 1/16	19/16	3	1 1/32	1 1/32	9/16	1 3/16	1.079	0.453	3/8	UCSFL201-8X56	SFL203	UC201-8X56	0.33	8.15	3.85	13.2	UCSFL204CS6	UCSFL204DS6	UCSFL204VCS6	UCSFL204VDS6	46	1 13/16	0.47	
15	98	52	24	76.5	12	10	14	29.9	27.4	11.5	M10	UCSFL202X56	SFL203	UC202X56	0.33	8.15	3.85	13.2	UCSFL204CS6	UCSFL204DS6	UCSFL204VCS6	UCSFL204VDS6	46	1 13/16	0.47	
17												UCSFL202-10X56	SFL203	UC202-10X56	0.33	8.15	3.85	13.2	UCSFL204CS6	UCSFL204DS6	UCSFL204VCS6	UCSFL204VDS6	46	1 13/16	0.47	
17	4 7/16	2 3/8	1 1/32	3 35/64	1 1/32	1 1/32	1 1/32	1 3/16	1.220	0.500	3/8	UCSFL203X56	SFL204	UC203X56	0.47	10.9	5.35	13.2	UCSFL204CS6	UCSFL204DS6	UCSFL204VCS6	UCSFL204VDS6	46	1 13/16	0.47	
20	113	60	26	90	12	10	15	33.3	31	12.7	M10	UCSFL204-1256	SFL204	UC204-1256	0.47	10.9	5.35	13.2	UCSFL204CS6	UCSFL204DS6	UCSFL204VCS6	UCSFL204VDS6	46	1 13/16	0.47	
25												UCSFL205-1456	SFL205	UC205-1456	0.61	11.9	6.30	13.9	UCSFL206CS6	UCSFL206DS6	UCSFL206VCS6	UCSFL206VDS6	58	2 9/32	0.9	
25	5 1/8	2 11/16	1 3/32	3 57/64	5/8	1 1/32	5/8	1 13/32	1.343	0.563	1/2	UCSFL205-1556	SFL205	UC205-1556	0.61	11.9	6.30	13.9	UCSFL206CS6	UCSFL206DS6	UCSFL206VCS6	UCSFL206VDS6	58	2 9/32	0.9	
25	130	68	27.5	99	16	10	16	35.8	34.1	14.3	M14	UCSFL205-1656	SFL205	UC205-1656	0.61	11.9	6.30	13.9	UCSFL206CS6	UCSFL206DS6	UCSFL206VCS6	UCSFL206VDS6	58	2 9/32	0.9	
30												UCSFL206-1856	SFL206	UC206-1856	0.9	16.5	9.05	13.9	UCSFL206CS6	UCSFL206DS6	UCSFL206VCS6	UCSFL206VDS6	58	2 9/32	0.9	
30	5 13/16	3 9/32	1 7/32	4 19/32	5/8	1 1/32	45/64	1 19/32	1.500	0.626	1/2	UCSFL206-1856	SFL206	UC206-1856	0.9	16.5	9.05	13.9	UCSFL206CS6	UCSFL206DS6	UCSFL206VCS6	UCSFL206VDS6	58	2 9/32	0.9	
30	148	80	31	117	16	10	18	40.2	38.1	15.9	M14	UCSFL206-1956	SFL206	UC206-1956	0.9	16.5	9.05	13.9	UCSFL206CS6	UCSFL206DS6	UCSFL206VCS6	UCSFL206VDS6	58	2 9/32	0.9	
35												UCSFL207-2056	SFL207	UC207-2056	1.1	21.8	12.3	13.9	UCSFL207CS6	UCSFL207DS6	UCSFL207VCS6	UCSFL207VDS6	62.5	2 15/32	1.1	
35	6 11/32	3 11/32	1 11/32	5 1/8	5/8	7/16	3/4	1 3/4	1.689	0.689	1/2	UCSFL207-2156	SFL207	UC207-2156	1.1	21.8	12.3	13.9	UCSFL207CS6	UCSFL207DS6	UCSFL207VCS6	UCSFL207VDS6	62.5	2 15/32	1.1	
35	161	85	34	130	16	11	19	44.4	42.9	17.5	M14	UCSFL207-2256	SFL207	UC207-2256	1.1	21.8	12.3	13.9	UCSFL207CS6	UCSFL207DS6	UCSFL207VCS6	UCSFL207VDS6	62.5	2 15/32	1.1	
40												UCSFL207-2356	SFL208	UC207-2356	1.4	24.8	14.3	14.0	UCSFL208CS6	UCSFL208DS6	UCSFL208VCS6	UCSFL208VDS6	70	2 3/4	1.4	
40	6 7/8	3 11/16	1 13/32	5 43/64	5/8	1 1/32	53/64	2 1/32	1.937	0.748	1/2	UCSFL207-2356	SFL208	UC207-2356	1.4	24.8	14.3	14.0	UCSFL208CS6	UCSFL208DS6	UCSFL208VCS6	UCSFL208VDS6	70	2 3/4	1.4	
45												UCSFL208-2456	SFL209	UC208-2456	1.6	27.8	16.2	14.0	UCSFL209CS6	UCSFL209DS6	UCSFL209VCS6	UCSFL209VDS6	75.5	2 31/32	1.6	
45	7 13/32	3 9/16	1 1/2	5 53/64	3/4	1/2	59/64	2 1/16	1.937	0.748	5/8	UCSFL208-2456	SFL209	UC208-2456	1.6	27.8	16.2	14.0	UCSFL209CS6	UCSFL209DS6	UCSFL209VCS6	UCSFL209VDS6	75.5	2 31/32	1.6	
45	188	100	38	148	19	13	22	52.2	49.2	19	M16	UCSFL209-2656	SFL209	UC209-2656	1.6	27.8	16.2	14.0	UCSFL209CS6	UCSFL209DS6	UCSFL209VCS6	UCSFL209VDS6	75.5	2 31/32	1.6	
50												UCSFL209-2756	SFL210	UC209-2756	1.9	29.8	18.6	14.4	UCSFL210CS6	UCSFL210DS6	UCSFL210VCS6	UCSFL210VDS6	82	3 15/64	1.9	
50	7 3/4	4 3/16	1 9/16	6 3/16	3/4	1/2	59/64	2 5/32	2.031	0.748	5/8	UCSFL209-2856	SFL210	UC209-2856	1.9	29.8	18.6	14.4	UCSFL210CS6	UCSFL210DS6	UCSFL210VCS6	UCSFL210VDS6	82	3 15/64	1.9	
50	197	106	40	157	19	13	22	54.6	51.6	19	M16	UCSFL210-3056	SFL210	UC210-3056	1.9	29.8	18.6	14.4	UCSFL210CS6	UCSFL210DS6	UCSFL210VCS6	UCSFL210VDS6	82	3 15/64	1.9	
2												UCSFL210-3156	SFL210	UC210-3156	1.9	29.8	18.6	14.4	UCSFL210CS6	UCSFL210DS6	UCSFL210VCS6	UCSFL210VDS6	82	3 15/64	1.9	
2												UCSFL210-3256	SFL210	UC210-3256	1.9	29.8	18.6	14.4	UCSFL210CS6	UCSFL210DS6	UCSFL210VCS6	UCSFL210VDS6	82	3 15/64	1.9	

Remarks
 1. In Part No. of unit and units with covers, fitting codes follow bore diameter numbers.
 2. Part No. of applicable grease fitting is A-1/4-28UNF1/3.
 3. For the dimensions and forms of applicable bearings, see the dimensional tables of ball bearing for unit.

Corrosion Resistant Series 2-Bolt Flange Units

UCSFL-ES6 Cylindrical bore (with set screws)

d 12 ~ 50 mm

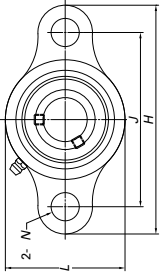
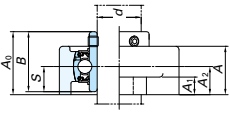

With Pressed Stainless Steel Cover

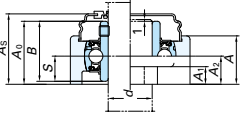

With Plastic Cover

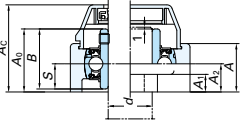

Variations of tolerance of distance from mounting surface to center of spherical bore (3 A₂) and variations of tolerance of distance between centers of bolt holes (3 A₁)

Housing No.	3 A ₂	3 A ₁	Unit: mm
SFL203E-SFL210E	±0.5	±0.5	±0.5

Variations of tolerance of bolt hole diameter (3 A₃)

Housing No.	3 A ₃	Unit: mm
SFL203E-SFL210E	±0.2	±0.2

Note: Cover groove is standard in all Stainless Steel housings.

Shaft Dia mm	inch	Dimensions											Bolt Size	Unit No.	Standard Housing No.	Bearing No.	Mass kg	Basic Load Ratings		Factor	With Pressed Stainless Steel Cover			With Plastic Cover				
		H	L	A	J	N	A ₁	A ₂	A ₃	B	S	mm						inch	C _r		C _{0r}	f ₀	Unit No.	Open Type	Closed Type	Dimension mm	inch	Mass kg
12	1/2	37/32	2 1/16	19/16	3	21/64	13/32	9/16	1 3/16	1.079	0.453	3/8	UCSFL201XE56	UC201X56	0.33	8.15	3.85	13.2	UCSFL204ECS6	UCSFL204EDS6	38	1 1/2	0.47	UCSFL204ECS6	UCSFL204EDS6	46	1 13/16	0.47
15	5/8	98	52	24	76.5	10	14	29.9	27.4	11.5	M10	UCSFL201-8XE56 UCSFL202XE56 UCSFL202-10XE56 UCSFL203XE56	SFL203E UC202X56 UC202-10X56 UC203X56	0.61	11.9	6.30	13.9	SFL205E	UCSFL205EDS6	40	1 9/16	0.61	UCSFL205ECS6	UCSFL205EDS6	49.5	1 61/64	0.61	
17	3/4	113	60	26	90	10	10	15	33.3	31	M10	UCSFL204-12XE56 UCSFL204E56	SFL204E UC204-1256 UC20456	0.47	10.9	5.35	13.2	SFL204E	UCSFL204EDS6	38	1 1/2	0.47	UCSFL204ECS6	UCSFL204EDS6	46	1 13/16	0.47	
20	7/8	130	68	27.5	99	12	10	16	35.8	34.1	M14	UCSFL205-14XE56 UCSFL205-15XE56 UCSFL205E56	UC205-1456 UC205-1556 UC20556	0.61	11.9	6.30	13.9	SFL205E	UCSFL205EDS6	40	1 9/16	0.61	UCSFL205ECS6	UCSFL205EDS6	49.5	1 61/64	0.61	
25	1	148	80	31	117	12	10	18	40.2	38.1	M14	UCSFL206-18XE56 UCSFL206E56	UC206-1856 UC20656	0.9	16.5	9.05	13.9	SFL206E	UCSFL206EDS6	45	1 15/32	0.9	UCSFL206ECS6	UCSFL206EDS6	58	2 9/32	0.9	
30	1 1/8	161	85	34	130	13	11	19	44.4	42.9	M14	UCSFL206-19XE56 UCSFL206E56 UCSFL207-20XE56	UC206-1956 UC206-2056 UC207-2056	1.1	21.8	12.3	13.9	SFL207E	UCSFL207EDS6	49	1 15/16	1.1	UCSFL207ECS6	UCSFL207EDS6	62.5	2 15/32	1.1	
35	1 1/4	175	94	36	144	13	12	21	51.2	49.2	M14	UCSFL207-21XE56 UCSFL207-22XE56 UCSFL207E56 UCSFL207-23XE56	UC207-2156 UC207-2256 UC20756 UC207-2356	1.4	24.8	14.3	14.0	SFL208E	UCSFL208EDS6	56	2 7/32	1.4	UCSFL208ECS6	UCSFL208EDS6	70	2 3/4	1.4	
40	1 1/2	188	100	38	148	15	13	22	52.2	49.2	M16	UCSFL208-24XE56 UCSFL208E56	UC208-2456 UC20856	1.6	27.8	16.2	14.0	SFL209E	UCSFL209EDS6	57	2 7/32	1.6	UCSFL209ECS6	UCSFL209EDS6	75.5	2 31/32	1.6	
45	1 3/4	197	106	40	157	15	13	22	54.6	51.6	M16	UCSFL209-26XE56 UCSFL209-27XE56 UCSFL209-28XE56 UCSFL209E56	UC209-2656 UC209-2756 UC209-2856 UC20956	1.9	29.8	18.6	14.4	SFL210E	UCSFL210EDS6	59	2 5/16	1.9	UCSFL210ECS6	UCSFL210EDS6	82	3 15/64	1.9	
50	1 7/8	219	120	44	171	16	14	24	59.1	56.1	M18	UCSFL210-30XE56 UCSFL210-31XE56 UCSFL210E56	UC210-3056 UC210-3156 UC21056	2.2	34.8	21.8	15.0	SFL210E	UCSFL210EDS6	62	2 3/8	2.2	UCSFL210ECS6	UCSFL210EDS6	82	3 15/64	2.2	

Remarks 1. In Part No. of unit and units with covers, fitting codes follow bore diameter numbers.

2. Part No. of applicable grease fitting is A-1/4-28UNF1.3.

3. For the dimensions and forms of applicable bearings, see the dimensional tables of ball bearing for unit.

Corrosion Resistant Series 2-Bolt Flange Units

USFL-S6 Cylindrical bore (with set screws) d 10 ~ 30 mm

With Through Type Cover

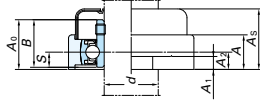

With One Side Sealed Cover

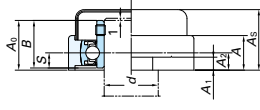

Variations of tolerance of distance from mounting surface to center of spherical bore (A2) and variations of tolerance of distance between centers of bolt holes (A1)

Housing No.	3 A2s	3 A1s	Unit: mm
SFL000-SFL006	±0.5	±0.4	±0.4

Note: Cover groove is standard in all Stainless Steel housings.

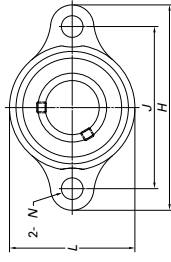

Shaft Dia. mm	Dimensions													Bolt Size	Unit No.	Standard Housing No.	Bearing No.	Mass kg	Basic Load Ratings		Factor	With Rubber Coated Cover		Mass kg
	H	L	A	J	N	A1	A2	A0	B	S	inch	mm	inch						mm	Cr		Cor	Open Type	
10	2 3/8	1 11/32	13/32	1 49/64	9/32	3/16	15/64	3/8	0.591	0.197	1/4	M6	SU00056	0.076	3.9	1.55	12.3	USFL000CS6	USFL000DS6	20.5	13/16	0.08		
	2 15/32	1 13/32	15/32	1 57/64	9/32	3/16	15/64	3/8	0.591	0.197	1/4	M6	SU00156	0.080	4.3	1.9	13.2	USFL001CS6	USFL001DS6	20.5	13/16	0.08		
15	2 3/8	1 5/8	1/2	2 3/32	9/32	1/4	1 11/16	0.650	0.217	1/4	M6	SU00256	0.1	4.7	2.25	13.9	USFL002CS6	USFL002DS6	22	7/8	0.1			
	2 25/32	1 23/32	9/16	2 13/64	9/32	1/4	9/32	0.689	0.236	1/4	M6	SU00356	0.13	5.1	2.6	14.4	USFL003CS6	USFL003DS6	23.5	15/16	0.13			
20	3 19/32	2 3/32	5/8	2 51/64	13/32	1/4	5/16	0.827	0.276	5/16	M8	SU00456	0.21	7.9	4	13.9	USFL004CS6	USFL004DS6	27	1 1/16	0.21			
	3 3/4	2 9/32	5/8	2 61/64	13/32	1/4	5/16	0.866	0.276	5/16	M8	SU00556	0.23	8.5	4.65	14.5	USFL005CS6	USFL005DS6	28	1 3/32	0.23			
30	4 11/32	2 19/32	23/32	3 11/32	1/2	9/32	23/64	1 17/32	0.965	0.295	3/8	M10	SU00656	0.33	11.2	6.6	14.7	USFL006CS6	USFL006DS6	31	1 7/32	0.33		
	110	66	18	85	13	7	9	26	24.5	7.5														

Remarks 1. In Part No. of unit and units with covers, fitting codes follow bore diameter numbers.
2. For the dimensions and forms of applicable bearings, see the dimensional tables of ball bearing for unit.

Corrosion Resistant Series 4-Bolt Flange Cartridge Units

UCSFC-S6 Cylindrical bore (with set screws) d 20 ~ 40 mm

With Pressed Stainless Steel Cover

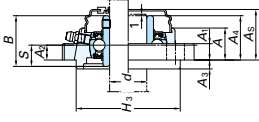

With Plastic Cover

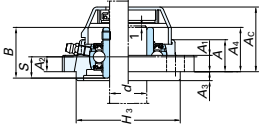

Variations of tolerance of spigot joint outside diameter (3 $f_{7/6}$), variations of tolerance of distance from mounting surface to center of spherical bore (3 $x_{2/2}$) and tolerance of position of bolt hole (X), and tolerance of circumferential runout of spigot joint (Y)

Housing No.	3 $f_{7/6}$	3 $x_{2/2}$	X	Y	Unit: mm
SFC204-SFC206	0	-0.046	±0.5	0.7	0.2
SFC207-SFC208	0	-0.054	±0.5	0.7	0.2

Variations of tolerance of bolt hole diameter (3 m)

Housing No.	3 m	Unit: mm
SFC204-SFC208	±0.2	

Note: Cover groove is standard in all Stainless Steel housings.

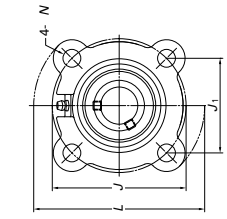

Shaft Dia mm	Dimensions inch mm																Bolt Size inch mm	Unit No.	Standard Housing No.	Bearing No.	Mass kg	Basic Load Ratings kN		Factor	With Pressed Stainless Steel Cover		With Plastic Cover		Mass kg		
	L	H ₃	J	J ₁	N	A	A ₁	A ₂	A ₃	A ₄	A ₅	B	S	C	C _{0r}	f ₀						Open Type	Unit No.		Dimension mm	Mass kg	Open Type	Unit No.		Dimension mm	Mass kg
20	3 15/16	2.4409	3 5/64	2 11/64	1 13/32	1 13/64	2 11/64	1 13/32	1 13/64	1 13/64	1 1/6	1.220	0.500	10.9	5.35	13.2	UC204-1256	SFC204	UC204-1256	UCSC204CS6	UCSFC204VDS6	32	1 1/4	0.54	UCSC204VDS6	UCSFC204VDS6	41	1 17/32	0.54		
25	7/8	4 17/32	2.7559	3 35/64	2 1/2	1 13/32	2 1/2	1 13/32	2 1/2	1 13/32	1 3/16	1.343	0.563	11.9	6.3	13.9	UC205-1456	SFC205	UC205-1456	UCSC205CS6	UCSFC205VDS6	34	1 11/32	0.72	UCSC205CS6	UCSFC205VDS6	43.5	1 23/32	0.72		
	1	115	70	90	63.6	12	21.5	10	10	6	29.8	34.1	14.3				UC205-1556		UC205-1556												
30	1 1/8	4 29/32	3.1496	3 15/16	2 25/32	1 13/32	2 5/8	1 13/32	2 5/8	1 13/32	1 13/16	1.500	0.626	16.5	9.05	13.9	UC206-1856	SFC206	UC206-1856	UCSC206CS6	UCSFC206VDS6	36	1 13/32	0.92	UCSC206CS6	UCSFC206VDS6	50	1 7/32	0.92		
	1 3/16	125	80	100	70.7	12	23	10	10	8	32.2	38.1	15.9				UC206-1956		UC206-1956												
35	1 1/4	5 1/16	3.5433	4 27/64	3 1/16	35/64	1 1/32	1 5/32	1 1/2	1 1/2	1 7/16	1.689	0.689	21.8	12.3	13.9	UC207-2056	SFC207	UC207-2056	UCSC207CS6	UCSFC207VDS6	41	1 5/8	1.24	UCSC207CS6	UCSFC207VDS6	54.5	2 3/64	1.24		
	1 3/8	135	90	110	77.8	14	26	12	11	8	36.4	42.9	17.5				UC207-2156		UC207-2156												
40	1 7/16	5 23/32	3.9370	4 23/32	3 11/32	35/64	1 1/32	1 13/32	1 1/2	1 1/2	1 3/4	1.937	0.748	24.8	14.3	14.0	UC207-2356	SFC208	UC207-2356	UCSC208CS6	UCSFC208VDS6	45	1 25/32	1.56	UCSC208CS6	UCSFC208VDS6	60	2 23/64	1.56		
	1 9/16	145	100	120	84.8	14	26	12	11	10	41.2	49.2	19				UC208-2456		UC208-2456												
																	UC208-2556		UC208-2556												

Remarks
1. In Part No. of unit and units with covers, fitting codes follow bore diameter numbers.
2. Part No. of applicable grease fitting is A-1/4-28UNFN13.
3. For the dimensions and forms of applicable bearings, see the dimensional tables of ball bearing for unit.

Corrosion Resistant Series Take-Up Units

UCST-56 Cylindrical bore (with set screws) d 20 ~ 50 mm

Variations of tolerance of groove width (B₄), variations of tolerance of distance between both grooves (3₁₁), and tolerance of symmetry of both groove sides (X)

Housing No.	Unit: mm		
	3 A ₁ s	3 A ₂ s	X
ST204~ST210	+0.2	0	-0.5

Note: Cover groove is standard in all Stainless Steel housings.

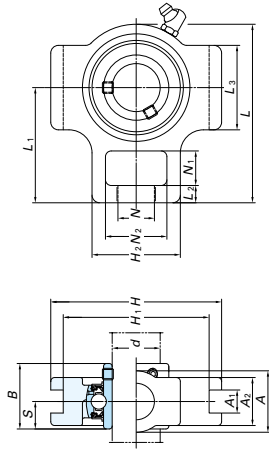
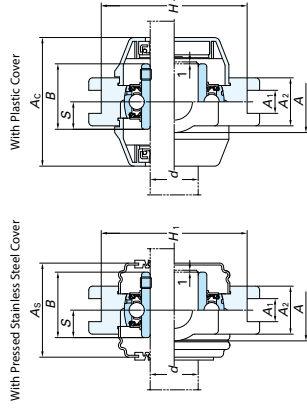

Shaft Dia. mm	Dimensions		Standard												Basic			With Pressed Stainless Steel Cover			With Plastic Cover			Mass kg
	inch	mm	Unit No.	Housing No.	Bearing No.	Mass kg	Load Ratings kN	Factor	Open Type	One Side Closed Type	Dimension mm	Mass kg	Open Type	One Side Closed Type	Dimension mm	Mass kg	Open Type	One Side Closed Type	Dimension mm	Mass kg				
20	3/4	1 1/4	15/32	29/32	3 1/2	2 65/64	1 13/16	3 1/2	2 3/16	1 13/32	1 23/32	3/4	2 3/32	1 1/4	1.220	0.500	UC204-1256	UC20456	UCST204VCS6	UCST204VCD56	62	2 7/16	0.73	
			32	12	23	89	76	46	89	59	9	44	19	18	32	31	12.7	UC205-1456	UC205156	UCST205VCS6	UCST205VCD56	45	1 25/32	0.73
25	7/8	1 1/4	15/32	31/32	3 1/2	2 65/64	1 13/16	3 1/2	2 3/16	1 13/32	1 23/32	3/4	2 3/32	1 1/4	1.343	0.563	UC205-1556	UC20556	UCST205VCS6	UCST205VCD56	49	1 15/16	0.79	
			32	12	25	89	76	46	93	60	9	44	19	18	32	34.1	14.3	UC205-1656	UC206-1856	UCST206VCS6	UCST206VCD56	53	2 3/32	1.1
30	1 1/8	1 1/2	15/32	15/32	4 1/16	3 1/2	2 1/16	4 3/16	2 3/8	1 13/32	1 31/32	7/8	2 3/32	1 15/32	1.500	0.626	UC206-1956	UC206-2056	UCST206VCS6	UCST206VCD56	60	2 3/8	1.5	
			37	12	27	102	89	52	106	67	9	50	22	18	37	38.1	15.9	UC207-2056	UC207-2156	UCST207VCS6	UCST207VCD56	69	2 23/32	2.0
35	1 1/4	1 1/2	15/32	15/32	4 1/32	3 1/2	2 7/32	4 13/16	2 15/16	7/16	2 7/32	7/8	2 3/32	1 15/32	1.689	0.689	UC207-2156	UC207-2256	UCST207VCS6	UCST207VCD56	87	3 37/64	1.5	
			37	12	31	102	89	56	119	75	11	56	22	18	37	42.9	17.5	UC208-2356	UC208-2456	UCST208VCS6	UCST208VCD56	98	3 51/64	2.0
40	1 1/2	1 3/4	15/16	5/8	1 1/4	4 1/2	4 1/64	2 29/32	5 3/16	3 11/32	9/16	2 17/32	1 3/32	2 5/32	1 15/16	1.937	0.748	UC208-2556	UC20856	UCST208VCS6	UCST208VCD56	107	4 7/32	2.1
			49	16	32	114	102	74	135	85	14	64	29	20	49	49.2	19	UC209-2656	UC209-2756	UCST209VCS6	UCST209VCD56	120	4 21/32	2.3
45	1 5/8	1 3/4	15/16	5/8	1 11/32	4 13/32	4 1/64	2 29/32	5 13/32	3 11/32	9/16	2 19/32	1 5/32	2 5/32	1 15/16	1.937	0.748	UC209-2656	UC209-2856	UCST209VCS6	UCST209VCD56	107	4 7/32	2.1
			49	16	34	117	102	74	137	85	14	66	29	20	49	49.2	19	UC210-3056	UC210-3156	UCST210VCS6	UCST210VCD56	120	4 21/32	2.3
50	1 7/8	1 3/4	15/16	5/8	1 3/8	4 19/32	4 1/64	2 29/32	5 3/8	3 7/16	9/16	2 27/32	1 5/32	2 5/32	1 15/16	2.031	0.748	UC210-3056	UC210-3256	UCST210VCS6	UCST210VCD56	120	4 21/32	2.3
			49	16	35	117	102	74	143	87	14	72	29	20	49	51.6	19	UC210-3156	UC21056	UCST210VCS6	UCST210VCD56	120	4 21/32	2.3

Remarks
 1. In Part No. of unit and units with covers, fitting codes follow bore diameter numbers.
 2. Part No. of applicable grease fitting is 6-1/4-28UNFN13.
 3. For the dimensions and forms of applicable bearings, see the dimensional tables of ball bearing for unit.

Corrosion Resistant Series Take-Up Units

UCST-ES6

Cylindrical bore (with set screws)

d 20 ~ 50 mm

With Pressed Stainless Steel Cover

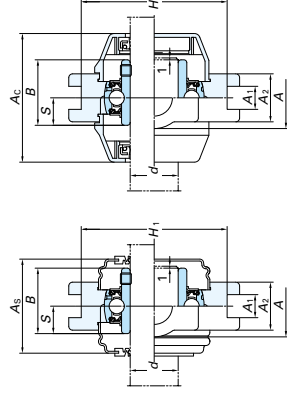

With Plastic Cover

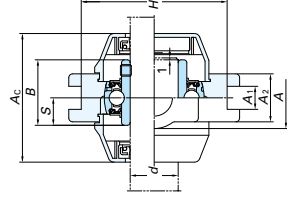

Variations of tolerance of groove width (B_{A1}), variations of tolerance of distance between both grooves (3_{A1}), and tolerance of symmetry of both groove sides (X)

Housing No.	Unit: mm		
	3 A ₁	3 A ₁ s	X
ST204E~ST210E	+0.2	0	-0.5

Note: Cover groove is standard in all Stainless Steel housings.

Shaft Dia. mm	Dimensions		Standard										Basic			With Pressed Stainless Steel Cover			With Plastic Cover		
	inch	mm	Unit No.	Housing No.	Bearing No.	Mass kg	Load Ratings kN	Factor	Open Type	One Side Closed Type	Dimension mm	Mass kg	Open Type	One Side Closed Type	Dimension mm	Mass kg	Open Type	One Side Closed Type	Dimension mm	Mass kg	
20	3/4	32	UCST204-12E56	ST204E	UC204-1256	0.73	10.9 5.35	13.2	UCST204ECS6	UCST204EVCDS6	45	0.73	UCST204ECS6	UCST204EVCDS6	62	0.73	UCST204ECS6	UCST204EVCDS6	62	0.73	
			UCST204E56		UC20456																
25	7/8	32	UCST205-14E56	ST205E	UC205-1456	0.79	11.9 6.3	13.9	UCST205ECS6	UCST205EVCDS6	49	0.79	UCST205ECS6	UCST205EVCDS6	68	0.79	UCST205ECS6	UCST205EVCDS6	68	0.79	
			UCST205E56		UC20556																
30	1 1/8	37	UCST206-18E56	ST206E	UC206-1856	1.1	16.5 9.05	13.9	UCST206ECS6	UCST206EVCDS6	53	1.1	UCST206ECS6	UCST206EVCDS6	80	1.1	UCST206ECS6	UCST206EVCDS6	80	1.1	
			UCST206E56		UC20656																
35	1 1/4	37	UCST207-21E56	ST207E	UC207-2156	1.5	21.8 12.3	13.9	UCST207ECS6	UCST207EVCDS6	60	1.5	UCST207ECS6	UCST207EVCDS6	87	1.5	UCST207ECS6	UCST207EVCDS6	87	1.5	
			UCST207E56		UC20756																
40	1 1/2	49	UCST208-24E56	ST208E	UC208-2456	2	24.8 14.3	14.0	UCST208ECS6	UCST208EVCDS6	69	2	UCST208ECS6	UCST208EVCDS6	98	2	UCST208ECS6	UCST208EVCDS6	98	2	
			UCST208E56		UC20856																
45	1 3/4	49	UCST209-27E56	ST209E	UC209-2756	2.1	27.8 16.2	14.0	UCST209ECS6	UCST209EVCDS6	69	2.1	UCST209ECS6	UCST209EVCDS6	107	2.1	UCST209ECS6	UCST209EVCDS6	107	2.1	
			UCST209E56		UC20956																
50	1 7/8	49	UCST210-31E56	ST210E	UC210-3156	2.3	29.8 18.6	14.4	UCST210ECS6	UCST210EVCDS6	74	2.3	UCST210ECS6	UCST210EVCDS6	120	2.3	UCST210ECS6	UCST210EVCDS6	120	2.3	
			UCST210E56		UC21056																

Remarks 1. In Part No. of unit and units with covers, fitting codes follow bore diameter numbers.
2. Part No. of applicable grease fitting is 6-1/4-28UNFN13.
3. For the dimensions and forms of applicable bearings, see the dimensional tables of ball bearing for unit.

Ball Bearing Inserts

UC-S6, SU-S6 (Stainless steel series) Cylindrical bore (with set screws) d 10 ~ 65 mm

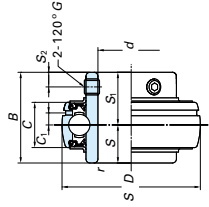

UC-S6

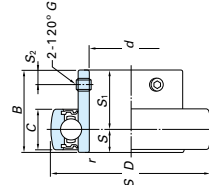

SU-S6

Notes: Cover groove is standard in all Stainless Steel housings.

Shaft Dia. mm	Dimensions										Basic Load Ratings kN	Factor f_0	Bearing No. Standard	Dimensions						Set Screw Brg. Bore G	Mass kg	
	D	B	C	r (min.)	C ₁	C ₂	S	S ₁	S ₂	S ₃				S ₄	S ₅	S ₆						
10	26	1.024	15	0.591	8	0.315	0.3	0.012	3.9	1.55	12.3	13.2	—	—	5	0.197	10	0.394	3	0.118	M3×0.35	0.024
12	28	1.102	15	0.591	8	0.315	0.3	0.012	4.3	1.9	13.2	13.2	3.5	0.138	11.5	0.453	15.9	0.626	4	0.158	M3×0.35	0.026
	40	1.575	27.4	1.079	13	0.512	0.6	0.024	8.15	3.85	13.2	13.2	3.5	0.138	11.5	0.453	15.9	0.626	4	0.158	M5×0.5	0.10
15	32	1.260	16.5	0.650	9	0.354	0.3	0.012	4.7	2.25	13.9	13.9	3.5	0.138	11.5	0.453	15.9	0.626	4	0.158	M5×0.5	0.10
	40	1.575	27.4	1.079	13	0.512	0.6	0.024	8.15	3.85	13.2	13.2	3.5	0.138	11.5	0.453	15.9	0.626	4	0.158	M5×0.5	0.10
17	35	1.378	17.5	0.689	10	0.394	0.3	0.012	5.1	2.6	14.4	14.4	3.5	0.138	11.5	0.453	15.9	0.626	4	0.158	M5×0.5	0.10
	40	1.575	27.4	1.079	13	0.512	0.6	0.024	8.15	3.85	13.2	13.2	3.5	0.138	11.5	0.453	15.9	0.626	4	0.158	M5×0.5	0.10
20	47	1.850	31	1.220	16	0.630	1	0.039	10.9	5.35	13.2	13.2	4	0.157	12.7	0.500	18.3	0.720	5	0.197	M6×0.75	0.16
	42	1.654	21	0.827	12	0.472	0.6	0.024	7.9	4	13.9	13.9	—	—	7	0.276	14	0.551	4	0.157	M5×0.5	0.080
25	47	1.850	31	1.220	16	0.630	1	0.039	10.9	5.35	13.2	13.2	4	0.157	12.7	0.500	18.3	0.720	5	0.197	M6×0.75	0.16
	52	2.047	34.1	1.343	17	0.669	1	0.039	11.9	6.3	13.9	13.9	5	0.197	14.3	0.563	19.8	0.780	5.5	0.217	M6×0.75	0.23
30	47	1.850	22	0.866	12	0.472	0.6	0.024	8.5	4.65	14.5	14.5	—	—	7	0.276	15	0.591	4.5	0.177	M6×0.75	0.20
	52	2.047	34.1	1.343	17	0.669	1	0.039	11.9	6.3	13.9	13.9	5	0.197	14.3	0.563	19.8	0.780	5.5	0.217	M6×0.75	0.20
35	52	2.047	34.1	1.343	17	0.669	1	0.039	11.9	6.3	13.9	13.9	—	—	7	0.276	15	0.591	4.5	0.177	M6×0.75	0.20
	62	2.441	38.1	1.500	19	0.748	1	0.039	16.5	9.05	13.9	13.9	5	0.197	15.9	0.626	22.2	0.874	6	0.236	M6×0.75	0.32
40	62	2.441	38.1	1.500	19	0.748	1	0.039	16.5	9.05	13.9	13.9	—	—	7	0.276	15	0.591	4.5	0.177	M6×0.75	0.20
	72	2.835	42.9	1.689	20	0.787	1.1	0.043	21.8	12.3	13.9	13.9	5.5	0.217	17.5	0.689	25.4	1.000	6.5	0.256	M6×0.75	0.30
45	72	2.835	42.9	1.689	20	0.787	1.1	0.043	21.8	12.3	13.9	13.9	—	—	7	0.276	15	0.591	4.5	0.177	M6×0.75	0.20
	85	3.346	49.2	1.937	22	0.866	1.1	0.043	27.8	16.2	14.0	14.0	5.5	0.217	17.5	0.689	25.4	1.000	6.5	0.256	M8×1	0.48
50	80	3.150	49.2	1.937	21	0.827	1.1	0.043	24.8	14.3	14.0	14.0	5.5	0.217	17.5	0.689	25.4	1.000	6.5	0.256	M8×1	0.48
	90	3.543	51.6	2.031	24	0.945	1.1	0.043	29.8	18.6	14.4	14.4	6	0.236	19	0.748	30.2	1.189	8	0.315	M8×1	0.60
55	90	3.543	51.6	2.031	24	0.945	1.1	0.043	29.8	18.6	14.4	14.4	6	0.236	19	0.748	30.2	1.189	8	0.315	M8×1	0.60
	100	3.937	55.6	2.189	25	0.984	1.5	0.059	36.8	23.5	14.4	14.4	6	0.236	19	0.748	30.2	1.189	8	0.315	M8×1	0.70
60	100	3.937	55.6	2.189	25	0.984	1.5	0.059	36.8	23.5	14.4	14.4	7	0.276	22.2	0.874	33.4	1.315	9	0.354	M10×1.25	1.15
	110	4.331	65.1	2.563	27	1.063	1.5	0.059	44.5	29	14.4	14.4	7	0.276	22.2	0.874	33.4	1.315	9	0.354	M10×1.25	1.15
65	110	4.331	65.1	2.563	27	1.063	1.5	0.059	44.5	29	14.4	14.4	7	0.276	22.2	0.874	33.4	1.315	9	0.354	M10×1.25	1.15
	120	4.724	65.1	2.563	28	1.102	1.5	0.059	48.6	32.1	14.4	14.4	7.5	0.295	25.4	1.000	39.7	1.563	12	0.472	M12×1.5	1.93
	120	4.724	65.1	2.563	28	1.102	1.5	0.059	48.6	32.1	14.4	14.4	7.5	0.295	25.4	1.000	39.7	1.563	12	0.472	M12×1.5	1.86

Remark: S6 series product is the stainless steel series ball bearing for unit.

JTEKT Europe Bearings BV
European Headquarter and Central Warehouse
Markerkant 13-01
1314 AL Almere, The Netherlands
☎ +31 (0)36 538 3333
✉ info-eu@jtekt.eu

Koyo Italia SRL
Territory: Italy
Via G. Stephenson 43a
20157 Milano, Italy
☎ +39 (0)22 951 0844
✉ koyo.italia@jtekt.eu

Koyo UK LTD
Territory: United Kingdom & Ireland
Whitehall Avenue, Kingston, Milton Keynes
Buckinghamshire MK10 OAX, U.K.
☎ +44 (0)19 082 89300
✉ sales@koyo.co.uk

Koyo Kullager Scandinavia AB
Territory: Sweden, Norway & Finland
Kanalvägen 5a
19461 Upplands-Väsby, Sweden
☎ +46 (0)85 942 1210
✉ kks-info@jtekt.eu

Koyo Romania Representative Office
Territory: Romania, Greece & Israel
Str. Dr. Lister 24, ap1
Sector 5, cod 050543 Bucarest, Romania
☎ +40 (0)21 410 4182
✉ carmen.berbecaru@jtekt.eu (Romanian territory)
✉ mariabianca.predut@jtekt.eu (Israelian & Greek territory)

JTEKT European Operations (Russia, Moscow office)
Territory: Russia, Belarus & Kazakhstan
125493 Russia, Moscow,
Avangardnaya str., 3, bld. 2, office 1505
☎ +7916 5922 8972
✉ alexey.fateev@jtekt.eu

Koyo Deutschland GMBH
Territory: Germany, Austria, Switzerland, Denmark, Turkey, Poland, Ukraine,
Bulgaria, Czech Republic, Hungary, Serbia & Montenegro, Croatia, Slovakia,
Slovenia, Bosnia & Herzegovina, Latvia, Estonia, Lithuania and Macedonia
Bargkoppelweg 4
22145 Hamburg, Germany
☎ +49 (0)40 679 0900
✉ info@jtekt.eu

Koyo France SA
Territory: France, Algeria, Morocco & Tunisia
1 rue François Jacob
92500 Rueil-Malmaison Cedex
☎ +33 (0)14 139 8000
✉ infokf@jtekt.eu

Koyo Iberica SL
Territory: Spain & Portugal
Centro de Negocios,
Calle La Mancha no.1 oficina 1.2
28823 Coslada (Madrid), Spain
☎ +34 (0)91 329 0818
✉ info-kib@jtekt.eu

Koyo Benelux Branch Office
Territory: Belgium, The Netherlands & Luxembourg
Markerkant 13-01
1314 AL Almere, The Netherlands
☎ +31 (0)36 538 3333
✉ info.Koyo.Benelux@jtekt.eu

JTEKT Poland Branch Office
3. Maja 14
41-200 Sosnowiec, Poland
☎ +48 (0)32 746 7777
✉ info-eu@jtekt.eu



www.koyo.eu << visit us at